

# 5.5" SQUARE DOWNLIGHT 10W TITANIUM LED SERIES

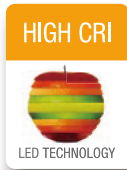

10W REPLACES



**65W Inc.**

80% Energy Savings

**CRISP**

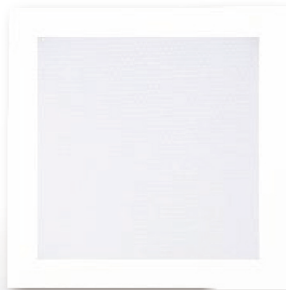

**\$190** Savings per lamp\*

- ⌚ Innovative **CLICK** design
- ⌚ **SootheOptic** low glare technology
- ⌚ Fits most 4" J-boxes and 6" recessed housings
- ⌚ Installs in just minutes - no rewiring
- ⌚ **Wet location rated**
- ⌚ Exceptional color rendering **CRI 90**



50,000 H



DIMMABLE



LOW GLARE



WARRANTY



CRI (Ra)



WET LOCATION



## DOWNLIGHT PRODUCT FEATURES

### Edge Lighting Technology

The CLICK DESIGN SURFACE MOUNT SQUARE & ROUND DOWNLIGHTS use the latest in edge lighting technology to produce a smooth uniform lighting effect. These naturally low glare downlights integrate seamlessly into all ceiling applications.



- BACK PLATE
- WATERPROOF FOAM
- EDGE LIGHTING REFLECTOR
- LIGHT GUIDE PLATE
- **SootheOptic** LOW GLARE
- TRIM

### SootheOptic Low Glare Technology

These downlights all feature SootheOptic technology that reduces high-angle light and minimizes visual glare. The smooth low glare diffuser gives each luminaire a soft cutoff without visible color separation.

#### Glare Control Diffuser

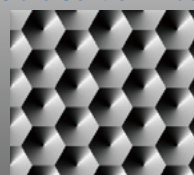

2.4mm Hex Pattern

#### Viewing Angle



0°

45°

>65°

# 5.5" SQUARE DOWNLIGHT 10W TITANIUM LED SERIES



## DUAL INSTALLATION

### 4" J-BOX FLUSHMOUNT

For all models

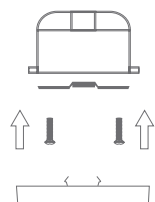

ACCESSORIES INCLUDED:

- Attach mounting bracket to J-box
- Click downlight into mounting bracket



Mounting Bracket



J-Box Screws



Wire Nuts



LED Adapter

### 4" & 6" CAN RECESSED

4" CAN - 5.5" & 7" models  
6" CAN - 7" model only

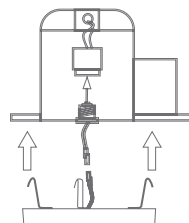

ACCESSORIES SOLD SEPARATELY:

- Connect E26 adapter to the LED adapter
- Insert mounting clips and push downlight up until flush with ceiling



E26 Adapter



Mounting Clips



Ground Screw



LED Adapter

## SPECIFICATIONS

Product Model	58247 10SMPS5.5DIM/927	58248 10SMPS5.5DIM/930	58249 10SMPS5.5DIM/940
<b>Type</b>	5.5" SMPS	5.5" SMPS	5.5" SMPS
<b>Base</b>	LED Adapter (E26 & GU24 optional)	LED Adapter (E26 & GU24 optional)	LED Adapter (E26 & GU24 optional)
<b>Power (W)</b>	10	10	10
<b>Voltage - Frequency</b>	120V 60Hz	120V 60Hz	120V 60Hz
<b>Color Temp. (ANSI)</b>	Soft White 2700K	Warm White 3000K	Cool White 4000K
<b>CRI (Ra)</b>	90	90	90
<b>Typical lumens (lm)</b>	550	550	560
<b>Efficacy (LPW)</b>	55	55	56
<b>Beam Angle</b>	100°	100°	100°
<b>Dimmable</b>	Yes**	Yes**	Yes**
<b>Housing Compatibility</b>	4" J-box / Most 6" housing	4" J-box / Most 6" housing	4" J-box / Most 6" housing
<b>Power Factor</b>	0.9	0.9	0.9
<b>Rated Lifetime - L70 (hrs.)</b>	50,000	50,000	50,000
<b>Dia. x MOL</b>	5.59"x1.65" (142x42mm)	5.59"x1.65" (142x42mm)	5.59"x1.65" (142x42mm)
<b>Weight (lb. / g)</b>	0.62lb. / 281g	0.62lb. / 281g	0.62lb. / 281g

## ACCESSORY ORDERING INFORMATION

Model	Product	Description
SMP/ACC	58033	4" or 6" Recessed Can Accessories for 5.5" & 7" Round & Square (5.5" for Use in 4" Can Only, 7" for Use in 4" or 6" Can)
23EMDRIVER	98003	California Title 20 Compliant 23W Emergency LED Driver (Field Installation)
21EMINVERTER	37935	California Title 20 Compliant 21W Emergency LED Inverter (Field Installation)

\* Savings per lamp based on \$0.11 / kw energy cost, 12 hrs / day lamp usage, \$4 incandescent with 1000-hr lifetime, \$30 LED with 50,000-hr lifetime

\*\* List of tested dimmer switches available on website