

9.5" CDL 45W TITANIUM LED SERIES



PRO



Patent Pending

- For retrofit or new construction installation
- Universal housing compatibility
- Adjustable lumen output – 3 defined light levels
- Easy fit installation – Spring-action housing clips
- Universal voltage 120-277V
- Available in 2700K, 3000K, 3500K & 4000K CCT



COMMERCIAL DOWNLIGHT PRODUCT FEATURES

Adjustable Lumen Output



Fluorescent Equivalence Table		
Power	Lumens	Equivalent
LOW-23.5W	2000	1X42W / 2X26W
MED-32W	2500	1X57W / 2X32W
HIGH-45W	3200	2X42W

This commercial downlight features adjustable lumen output for three distinct lumen levels equivalent to various CFL lamp combinations. Simply adjust the lamp power to the desired lumen output by sliding the selector switch on top of the fixture.

Easy-Fit Installation

The adjustable housing clips allow for installation in a large range of commercial and architectural housings ranging from 8.6"-10.4" (220-265mm). These spring-action clips push up easily and fit securely for both retrofit and new construction installations.

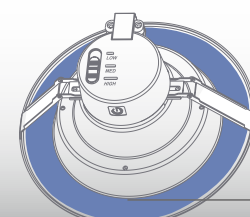
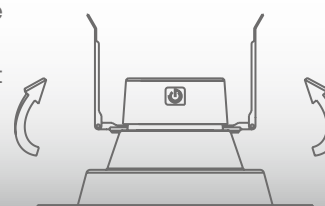
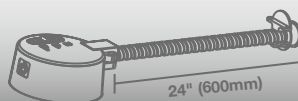

Min. 8.6" (220mm)
Max. 10.4" (265mm)

SIMPLE RETROFIT OR ECONOMICAL NEW CONSTRUCTION INSTALLATION

Retrofit Installation

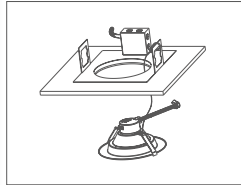

Attach safety clip

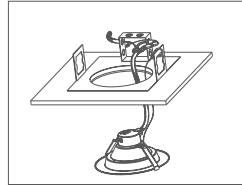

Bypass ballast & wire to j-box

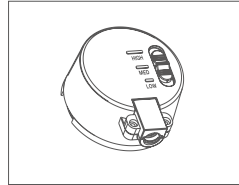

Adjust lumens to desired output

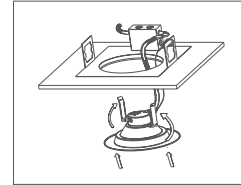

Push clips up & install into fixture

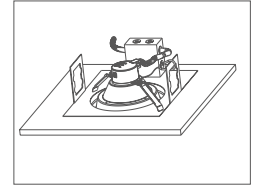

Ensure fixture is flush. Installation is complete

New Construction Installation

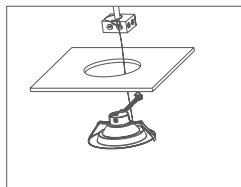

Attach safety clip

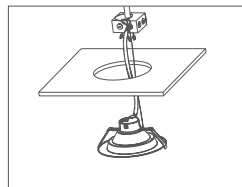

Wire to j-box

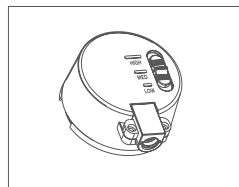

Adjust lumens to desired output

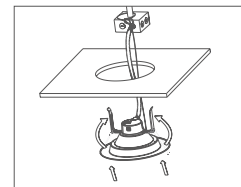

Push clips up & install into opening

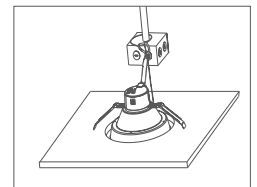

Ensure fixture is flush. Installation is complete

SPECIFICATIONS

Product Model	57878 45CDLA9.5/827/277V	57879 45CDLA9.5/830/277V	57880 45CDLA9.5/835/277V	57881 45CDLA9.5/840/277V
Type	9.5" Commercial Downlight	9.5" Commercial Downlight	9.5" Commercial Downlight	9.5" Commercial Downlight
Power (W)	23.5 / 32 / 45	23.5 / 32 / 45	23.5 / 32 / 45	23.5 / 32 / 45
Voltage - Frequency	120-277V 50-60Hz	120-277V 50-60Hz	120-277V 50-60Hz	120-277V 50-60Hz
Color Temp. (ANSI)	Soft White 2700K	Warm White 3000K	Neutral White 3500K	Cool White 4000K
CRI (Ra) (typ.)	80	80	80	80
Typical lumens (lm)	1860 / 2325 / 2975	2000 / 2500 / 3200	2000 / 2500 / 3200	2000 / 2500 / 3200
Efficacy (LPW)	79 / 73 / 66	85 / 78 / 71	85 / 78 / 71	85 / 78 / 71
Beam Angle	110°	110°	110°	110°
Dimmable	No	No	No	No
Power Factor	0.9	0.9	0.9	0.9
Temperature Rating	-13°F/-25°C - 95°F/35°C	-13°F/-25°C - 95°F/35°C	-13°F/-25°C - 95°F/35°C	-13°F/-25°C - 95°F/35°C
Rated Lifetime - L70 (hrs.)	40,000	40,000	40,000	40,000
Dia. x MOL	11.26"x4.84" (286x123mm)	11.26"x4.84" (286x123mm)	11.26"x4.84" (286x123mm)	11.26"x4.84" (286x123mm)
Weight (lb. / g)	2.02 lb. / 915g	2.02 lb. / 915g	2.02 lb. / 915g	2.02 lb. / 915g

* Suitable for damp locations. Not for use where directly exposed to weather or water

** Full installation guide and more details available on website