

# PXCYL2-FLANGELESS SM KIT INSTRUCTION SHEET

**WARNING** – Turn the power off at the circuit breaker before attempting to do any installation.

- Part List
- o Flangeless mounting plate assembled
  - o PXCYL2 FLANGELESS BASE PLATE



Fig. 1

1. Attach the Flangeless Mounting Plate to the ceiling junction box (using screws provided with the junction box). (fig.1)



Fig. 2

2. Smoothly apply spackling compound evenly up to the octagonal plate. Allow time for the compound to dry, sand smooth and apply paint/finish prior to mounting the fixture in the next step. (fig.2)

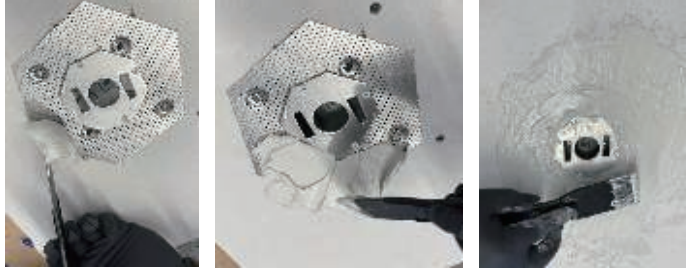
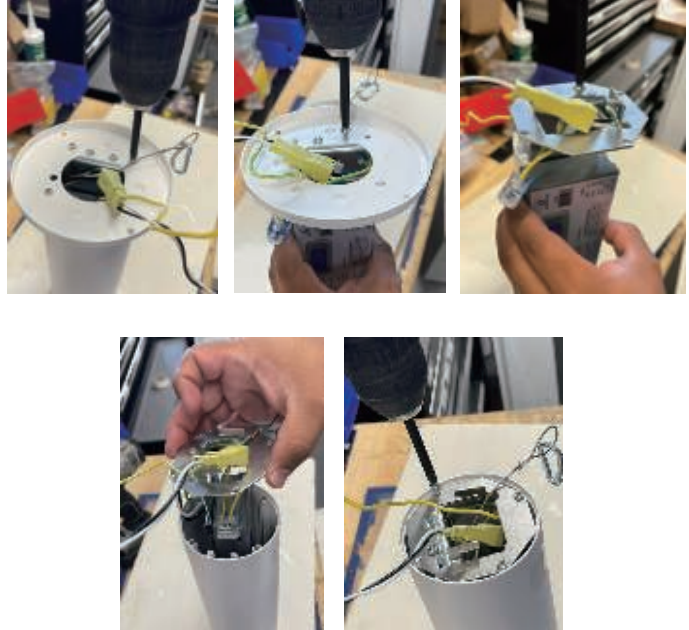

Fig. 3

3. Prepare your PXCYL2-FLANGELESS KIT, begin by removing the Surface mount kit installed. Also removed the driver assembly from this plate. Save the screws to re-attached them to the [PXCYL2 FLANGELESS BASE PLATE] and the PXCYL2. Make sure pulling the wires from the center cutout. (fig.3)



# PXCYL2-FLANGELESS SM KIT INSTRUCTION SHEET

4. Attach the safety cable as shown. Pull the supply wiring from the junction box through the center of the Mounting Plate. Make wiring connections per the installation instructions provided with the PXCYL luminaire. (fig.4)

Fig. 4



5. Align hooks with the cutouts, insert the hooks and rotate the fixture with firm pressure. Turn the fixture approximately 90° to the right until fully engaged. (fig.5)

Fig. 5

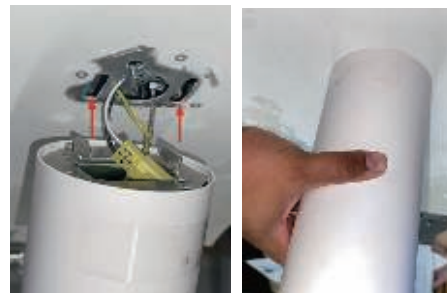

6. Installation is complete (fig.6)

Fig. 6

